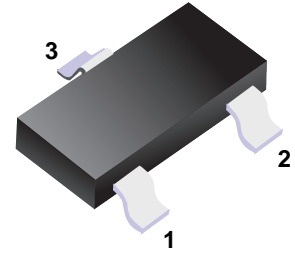
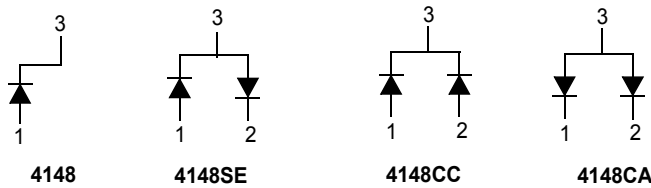

Switching Diodes
Features

- Fast Switching Speed
- For General Purpose Switching Applications
- High Conductance

Simplified outline(SOT-23)

Absolute Maximum Ratings Ta = 25°C

Parameter	Symbol	Rating	Unit
Reverse Voltage	V_{RM}	100	V
Peak Repetitive Peak Reverse Voltage	V_{RRM}	75	
Working Peak Reverse Voltage	V_{RWM}		
DC Blocking Voltage	V_R		
RMS Reverse Voltage	V_{RMS}	53	mA
Average Rectified Output Current	I_o	150	
Peak Forward Surge Current	I_{FM}	300	A
Peak Forward Surge Current @ t=1μs	I_{FSM}	2	
@ t=1s		1	
Power Dissipation	P_d	350	mW
Thermal Resistance Junction to Ambient	$R_{\theta JA}$	357	°C/W
Junction Temperature	T_J	150	°C
Storage Temperature range	T_{stg}	-55 to 150	

Electrical Characteristics Ta = 25°C

Parameter	Symbol	Test Conditions	Min	Typ	Max	Unit
Reverse breakdown voltage	V_R	$I_R=100\ \mu A$	75			V
Forward voltage	V_{F1}	$I_F=1\ mA$			0.715	
	V_{F2}	$I_F=10\ mA$			0.855	
	V_{F3}	$I_F=50\ mA$			1	
	V_{F4}	$I_F=150\ mA$			1.25	
Reverse voltage leakage current	I_{R1}	$V_R=75\ V$			2.5	μA
	I_{R2}	$V_R=20\ V$			25	nA
Capacitance between terminals	C_T	$V_R=0\ V, f=1\ MHz$			2	pF
Reverse recovery time	t_{rr}	$I_F=I_R=10mA, I_{rr}=0.1xI_R, R_L=100\ \Omega$			4	ns

Marking

NO	MMBD4148	MMBD4148SE	MMBD4148CC	MMBD4148CA
Marking	5D	D4	D5	D6

■ Typical Characteristics

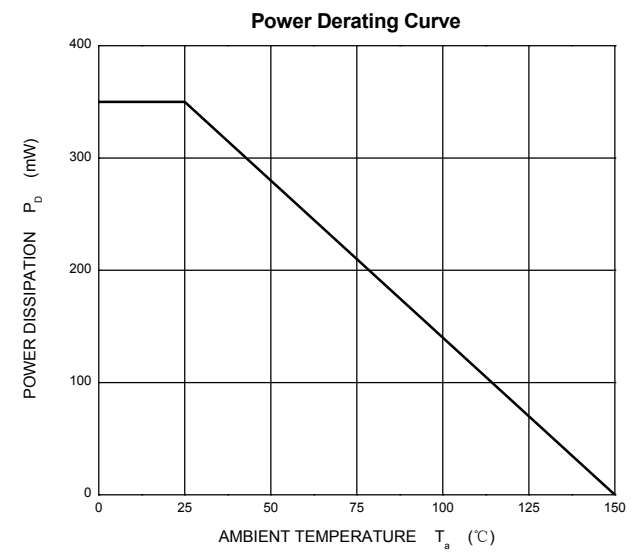
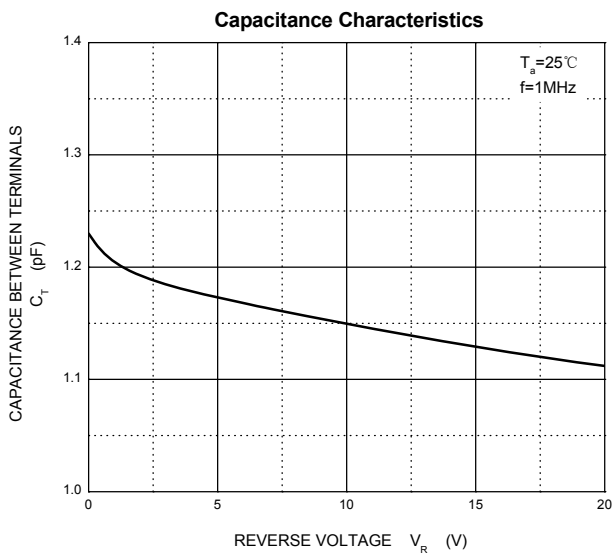
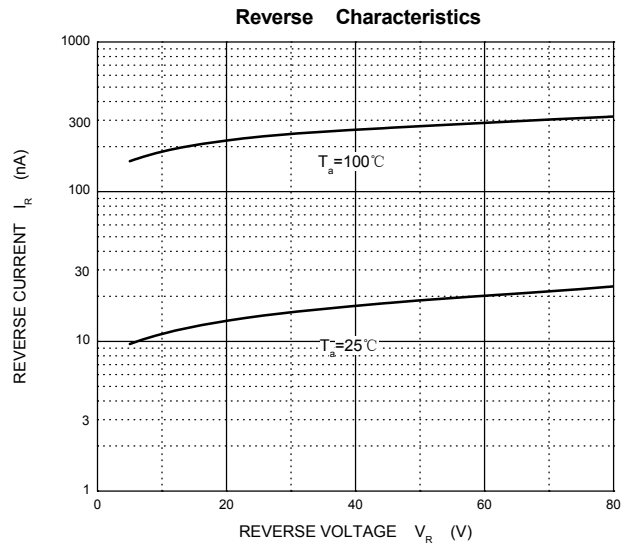
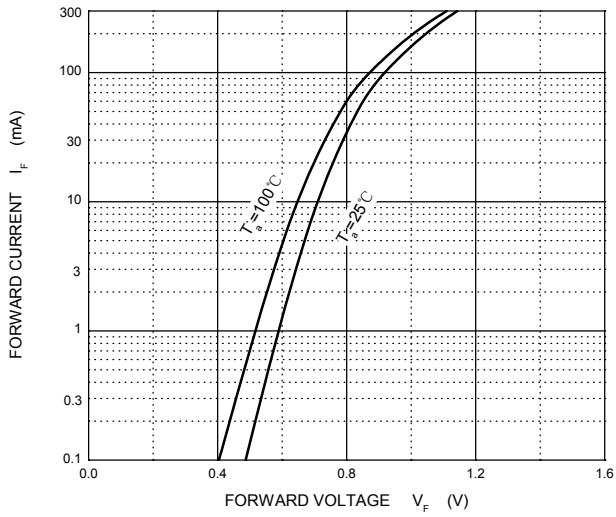

■ SOT-23

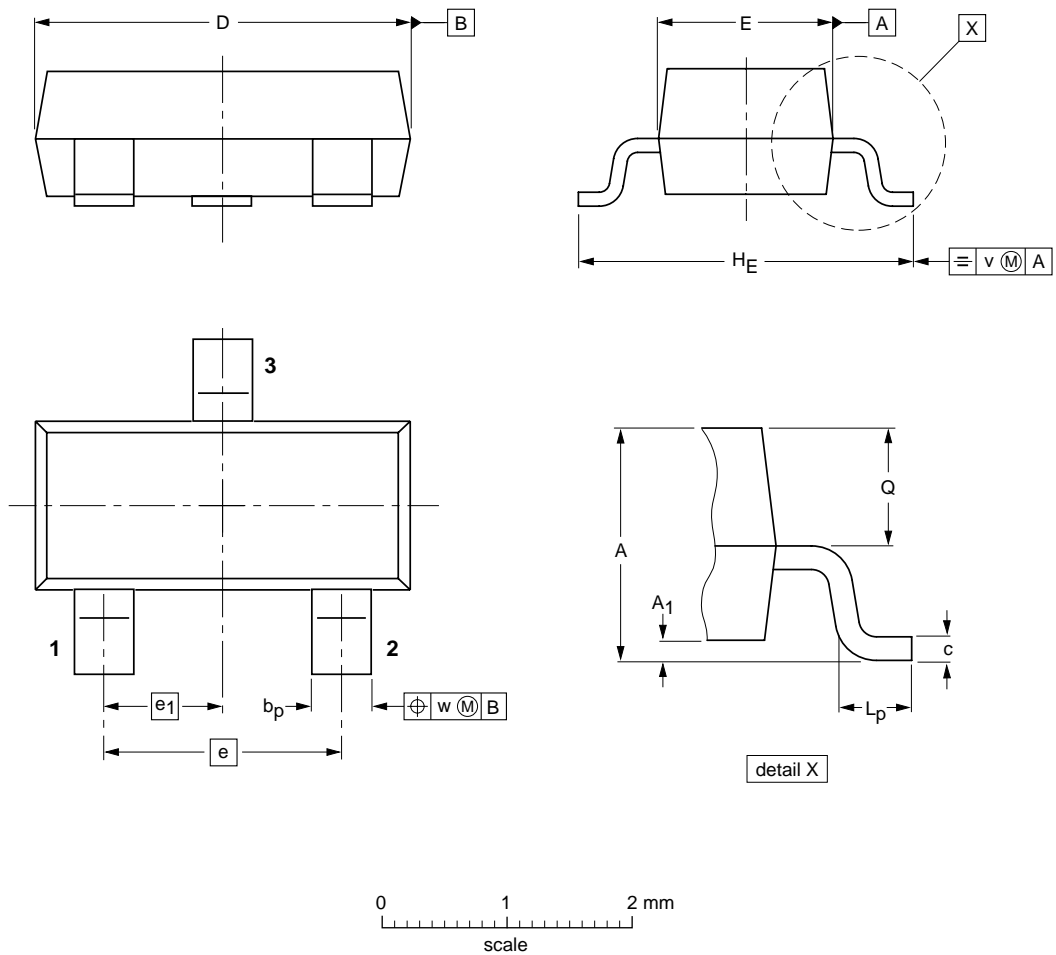

DIMENSIONS (mm are the original dimensions)

UNIT	A	A ₁ max.	b _p	c	D	E	e	e ₁	H _E	L _p	Q	v	w
mm	1.1 0.9	0.1	0.48 0.38	0.15 0.09	3.0 2.8	1.4 1.2	1.9	0.95	2.5 2.1	0.45 0.15	0.55 0.45	0.2	0.1